

Manufacturer: Willowcrete Manufacturing Co. Ltd. Deptford Terrace, Sunderland, Tyne & Wear, SR4 6DF

Intended use: Concrete lintel intended for use in walls and partitions

Assessment and verification of constancy of performance: System 3

Relevant Harmonised Standard: EN 845-2:2013

CERAM, Queens Rd, Penkhull, Stoke-on-Trent, ST4 7LQ (Notified Body No : 1289) - 8.2 Initial Type Testing - Ref: 114437 (QT-18539/2/BW) /Ref: 1.0A

Declared Performance

Lintel Length (mm)	Load Bearing Capacity (kN)	Deflection at 1/3 of Load Capacity (mm)
600	87.43	0.15
750	65.44	0.22
900	52.21	0.30
1050	43.38	0.40
1200	37.04	0.51
1350	32.28	0.63
1500	28.56	0.77
1650	25.56	0.92
1800	23.11	1.07
2100	19.29	1.42
2400	16.46	1.81
2700	14.26	2.24
3000	12.49	2.69

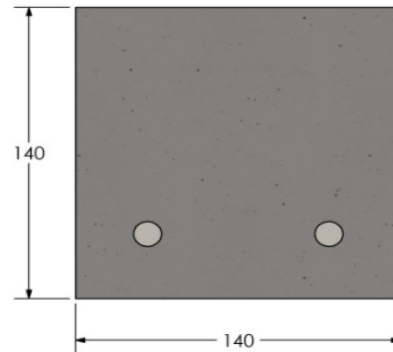

Fire Resistance	NPD
Mass	0.50 kN/m
Water Absorption	NPD
Water Vapour Permeability	NPD
Dangerous Substances	None
Durability (Against Corrosion):	C2
Durability (Against Freeze/Thaw):	Resistant

The performance of the product identified is in conformity with the declared performance above. This declaration of performance is issued under the sole responsibility of the manufacturer identified.

Issued By: Jeff Broomfield (Managing Director)

Date: 02/10/2017

J. A. Broomfield