

Manufacturer: Willowcrete Manufacturing Co. Ltd. Deptford Terrace, Sunderland, Tyne & Wear, SR4 6DF

Intended use: Concrete lintel intended for use in walls and partitions

Assessment and verification of constancy of performance: System 3

Relevant Harmonised Standard: EN 845-2:2013

CERAM, Queens Rd, Penkull, Stoke-on-Trent, ST4 7LQ (Notified Body No : 1289) - 8.2 Initial Type Testing - Ref: 114437 (QT-18539/2/BW) /Ref: 1.0A

Declared Performance

Lintel Length (mm)	Load Bearing Capacity (kN)	Deflection at 1/3 of Load Capacity (mm)
600	90.48	0.40
750	67.76	0.58
900	54.10	0.81
1050	44.98	1.06
1200	38.45	1.36
1350	33.54	1.69
1500	29.71	2.05
1650	26.64	2.44
1800	24.11	2.87
2100	20.20	3.82
2400	17.31	4.89
2700	15.07	6.06
3000	13.28	7.32

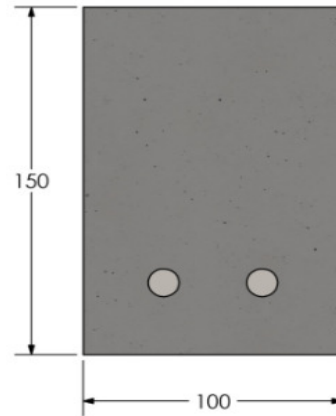

Fire Resistance	NPD
Mass	0.50 kN/m
Water Absorption	NPD
Water Vapour Permeability	NPD
Dangerous Substances	None
Durability (Against Corrosion):	C2
Durability (Against Freeze/Thaw):	Resistant

The performance of the product identified is in conformity with the declared performance above. This declaration of performance is issued under the sole responsibility of the manufacturer identified.

Issued By: Jeff Broomfield (Managing Director)

Date: 02/10/2017

